



La Habra, California

BOILER LOCATIONS

(FOR BUILDINGS SERVICED, SEE REVERSE)

Entrance

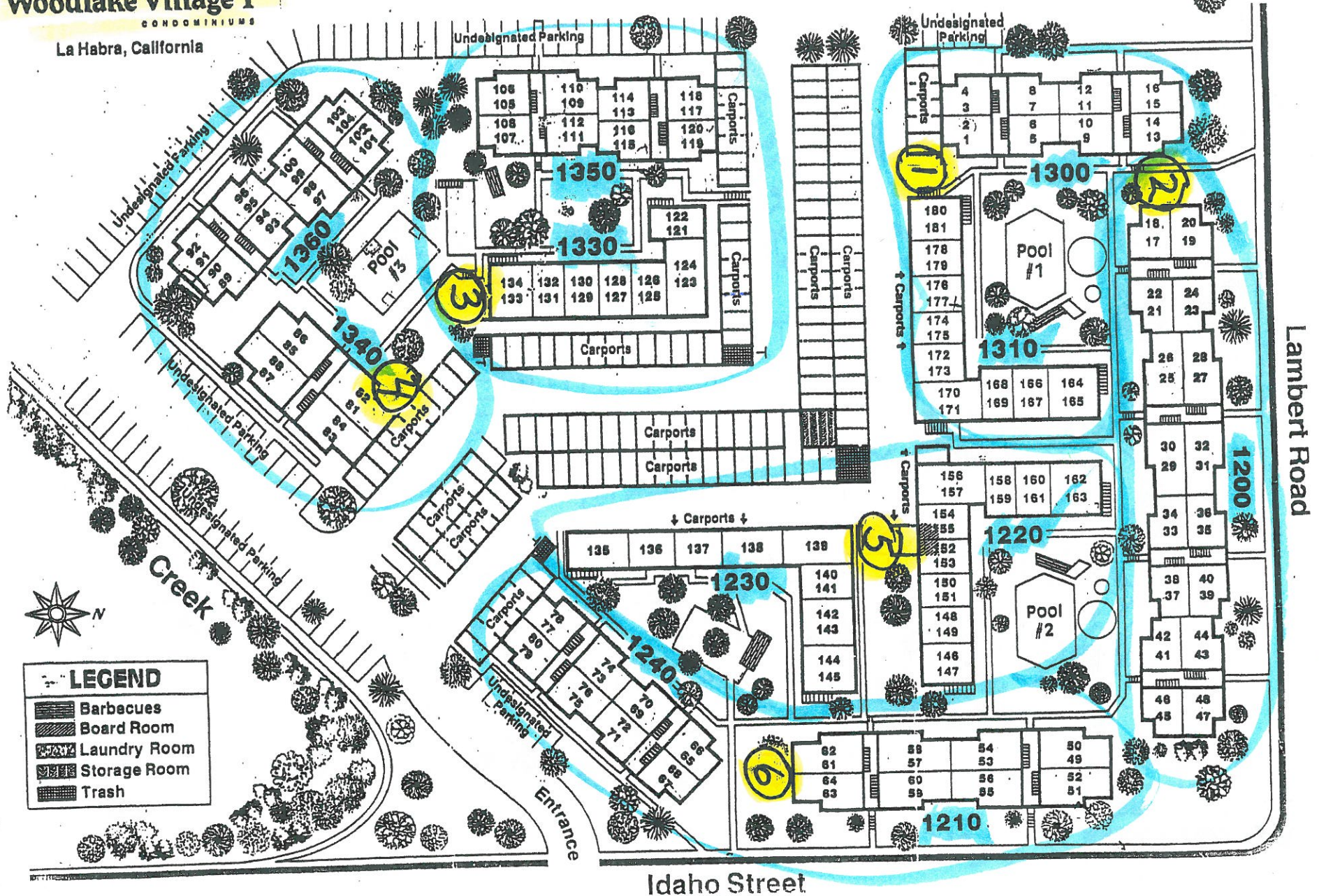

WOODLAKE VILLAGE I COMMUNITY ASSOCIATION

1200 – 1360 W. Lambert Rd., La Habra, CA 90631

BOILER INFORMATION LIST:

NOTE: For "No Hot Water" problems, call Benrich ONLY: 714-241-0284

When a resident requests information from management regarding shutting down the Boiler so they can perform "NON-EMERGENCY" repairs or maintenance in their unit:

1. **FINANCIAL RESPONSIBILITY:** The homeowner must contact the boiler vendor directly as the homeowner is financially responsible to pay Benrich for the costs to shut down and re-start the boiler. To eliminate the H/O having to pay 2 vendors, notify the homeowner that Benrich does plumbing and suggest they call Benrich for a price quote on the "complete" job. Do not assign an Association purchase order for these jobs.
2. **NOTIFICATION OF WATER SHUT-OFF:** The homeowner is responsible to notify all residents impacted by the boiler shut down by posting a written notice to each door of those residents serviced by that boiler or by the mailboxes of the building impacted, 24-48 hours before the work is to start. The notice must state the date and the approx. time the water will be shut off. (e.g. "the water will be shut off on Friday, April 30, 2004 between 9:00 a.m. to 12:00 noon for non-emergency repair/maintenance").
3. **BOILER SHUT DOWN FOR SCHEDULED REPAIRS/MAINT:** If Benrich must shut down the boiler for a scheduled repair, they must post a written notice either to each resident's door serviced by that boiler or by the mailboxes of the building(s) impacted, 24-48 hours before the work begins.

The building and unit numbers corresponding to each Boiler are shown below:

Boiler # 1 (padlocked), located alongside Laundry Room #1 by the 1310 building services the 1300 & 1310 buildings and these unit numbers:

#1300, units #1-16 AND #1310, units # 164 - 181

Boiler #2, (padlocked), located between the 1200 & 1300 buildings by Lambert Rd services the 1200 building only and these unit's #17-48

Boiler #3, (deadbolt), located alongside Laundry Room #3 in back of the 1330 building services the 1330 & 1350 buildings and these unit numbers:

#1330, units # 121 – 134 AND #1350, units # 105 – 120

Boiler #4 (deadbolt), located in the NE corner of the center court area by pool #3 in front of unit #81 services the 1340 & 1360 buildings and these unit numbers:

#1340, units # 81 – 88 AND #1360, units # 89 – 104

Boiler #5, (padlocked), located in the carport area alongside Laundry Room #2 & behind the 1220 building services the 1220 and 1230 buildings and these unit numbers:

#1220, units # 146 – 163 AND #1230, units # 135 – 145

Boiler #6, (padlocked), located at the south end of the 1210 building on the top of the slope by Idaho St. services the 1210 & 1240 buildings and these unit numbers:

#1210, units #49 – 64 AND #1240, units #65 – 80