

Avalon Eaves Tustin

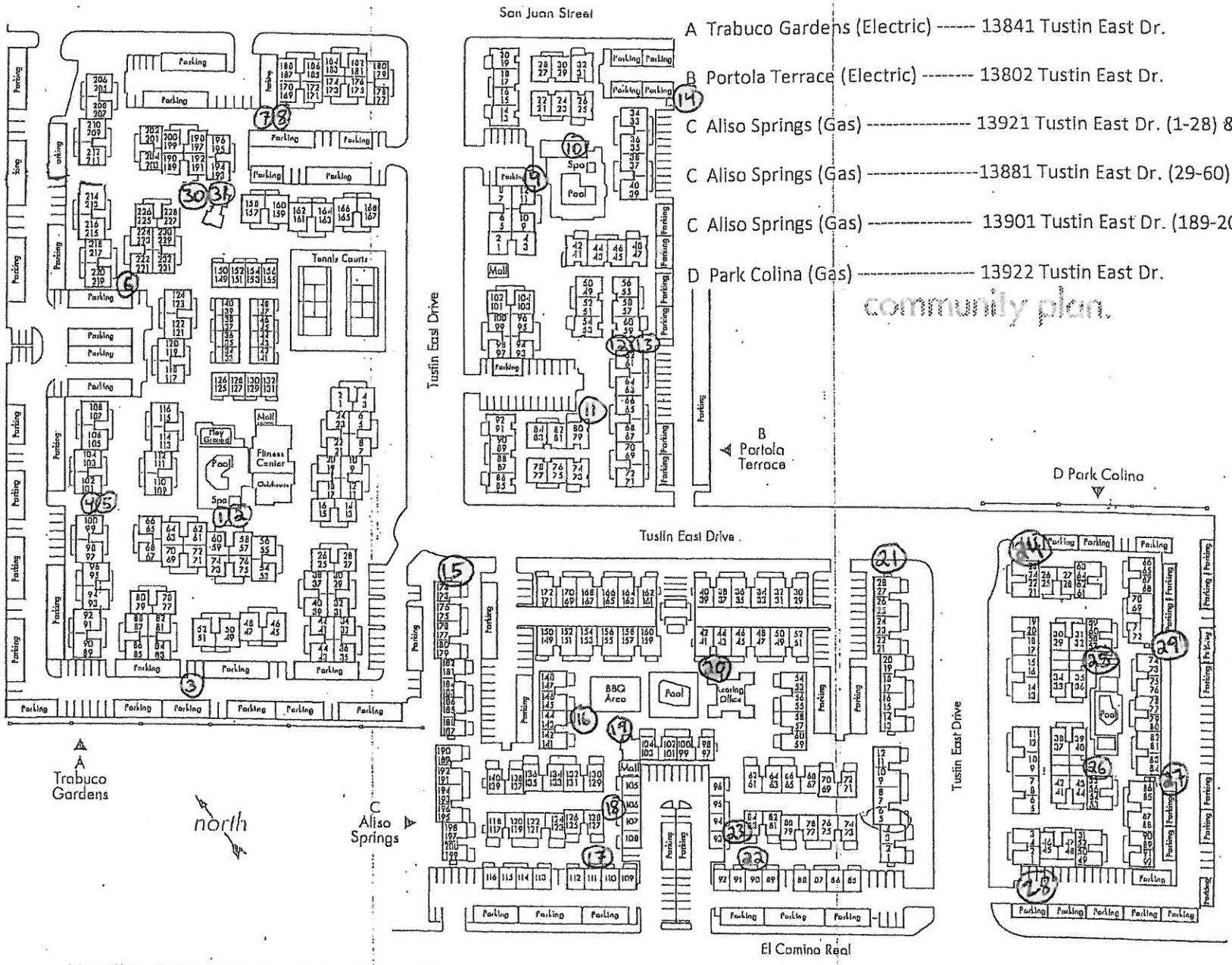

- A Trabuco Gardens (Electric) ----- 13841 Tustin East Dr.
- B Portola Terrace (Electric) ----- 13802 Tustin East Dr.
- C Aliso Springs (Gas) ----- 13921 Tustin East Dr. (1-28) & (61-88)
- C Aliso Springs (Gas) ----- 13881 Tustin East Dr. (29-60) & (141-188)
- C Aliso Springs (Gas) ----- 13901 Tustin East Dr. (189-200) & (89-140)
- D Park Colina (Gas) ----- 13922 Tustin East Dr.

community plan.



We would like to take you on a standard tour route that may include a model apartment and many community amenities. If you wish to alter this route, see a specific apartment or see other community features, we can do so upon request. This plan is intended for illustrative purposes only.



BENRICH SERVICE COMPANY, INC.
3190-G Airport Loop Drive
Costa Mesa, CA 92626
www.benrichservice.com
Tel: 714.241.0284
Fax: 714.662.5516
License #502927

February 27, 2013

Todd Sullivan
Avalon Bay Communities
4440 Von Karman Ave, Suite 300
Newport Beach, CA 92660

Dear Todd,

After inspecting The Eaves in Tustin, I found that the water heating systems consist of mostly Raytherm WH1-401 boilers and 100 gallon water heaters (mix of Bradford Whites, American Standards and Universals). Here is a list that goes along with the map I have provided:

Block A:

1. Water Heater
2. Water Heater
3. Raytherm 401 Boiler ground level
4. Water Heater
5. Water Heater
6. Raytherm 401 Boiler ground level
7. Water Heater
8. Water Heater
30. Water Heater
31. Water Heater

Block B:

9. Water Heater
10. Water Heater
11. Water Heater
12. Water Heater
13. Water Heater
14. Water Heater

Block C:

15. Raytherm 401 Boiler second level (**Ladder has been removed to access boiler on second level. Needs to be put back in place for access**)
16. Raytherm 401 Boiler second level (**bottom half of ladder has been cut, need a short ladder to reach it**)
17. Raytherm 401 Boiler ground level
18. Raytherm 401 Boiler ground level
19. Water Heater

- 20. 40 Gallon Water Heater (No PM needed)
- 21. Raytherm 401 Boiler second level, ladder ok
- 22. PW 400 Boiler ground level
- 23. Raytherm 401 Boiler ground level

Block D:

- 24. Water Heater
- 25. Water Heater
- 26. Water Heater
- 27. Water Heater
- 28. Water Heater
- 29. Water Heater

In total you have (21) commercial water heaters and (9) boilers. I excluded #20 which is a 40 gallon water heater and doesn't require PM. Please note that #30 and #31 are in Block A. My numbering is based off of what was written on each storage tank or water heater.

I have attached (2) proposals – one for the boiler PM and the other for water heater de-scaling.

After approval, please sign and return a copy of the agreement to our office and we will schedule the initial services. We appreciate working with you and look forward to maintaining this property's heating systems!

Sincerely,



Tanner Bendheim
Sales Representative



Scan with smart phone app to view
Benrich videos and website information